

Campsite or Trail Boarder



Latrine



Tent Platform



Bridge



Part of trail not drawn for mapping purposes

The numbers drawn on maps depict Maximum Capacity for that area in the campsite. Example: 4-6 means 4 to 6 scouts or 2 to 3 tents.

For tent dimensions we used official BSA Scout tents 7' x 9'.

Blackhawk

Many Point Lake

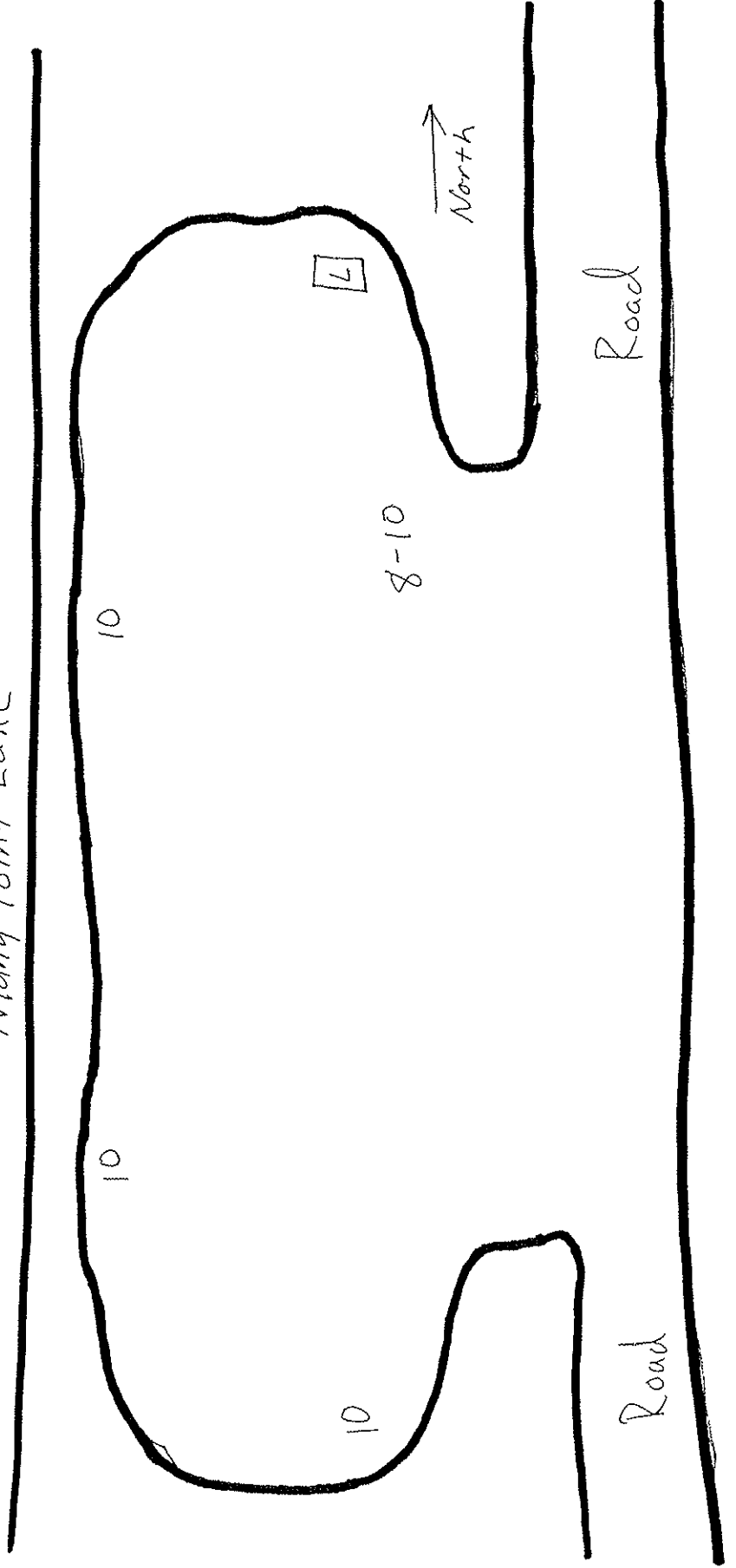

Cochise

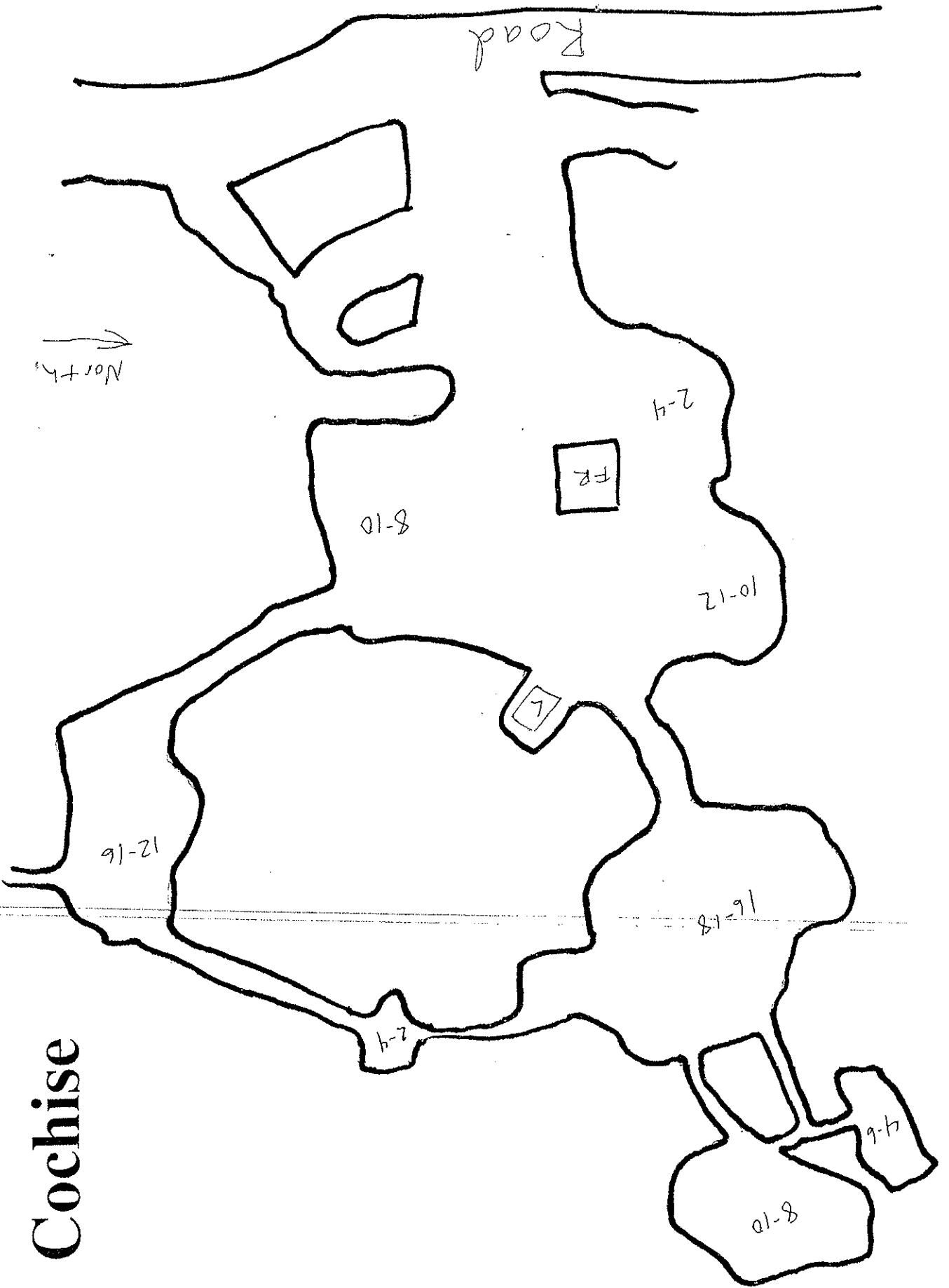

Joseph

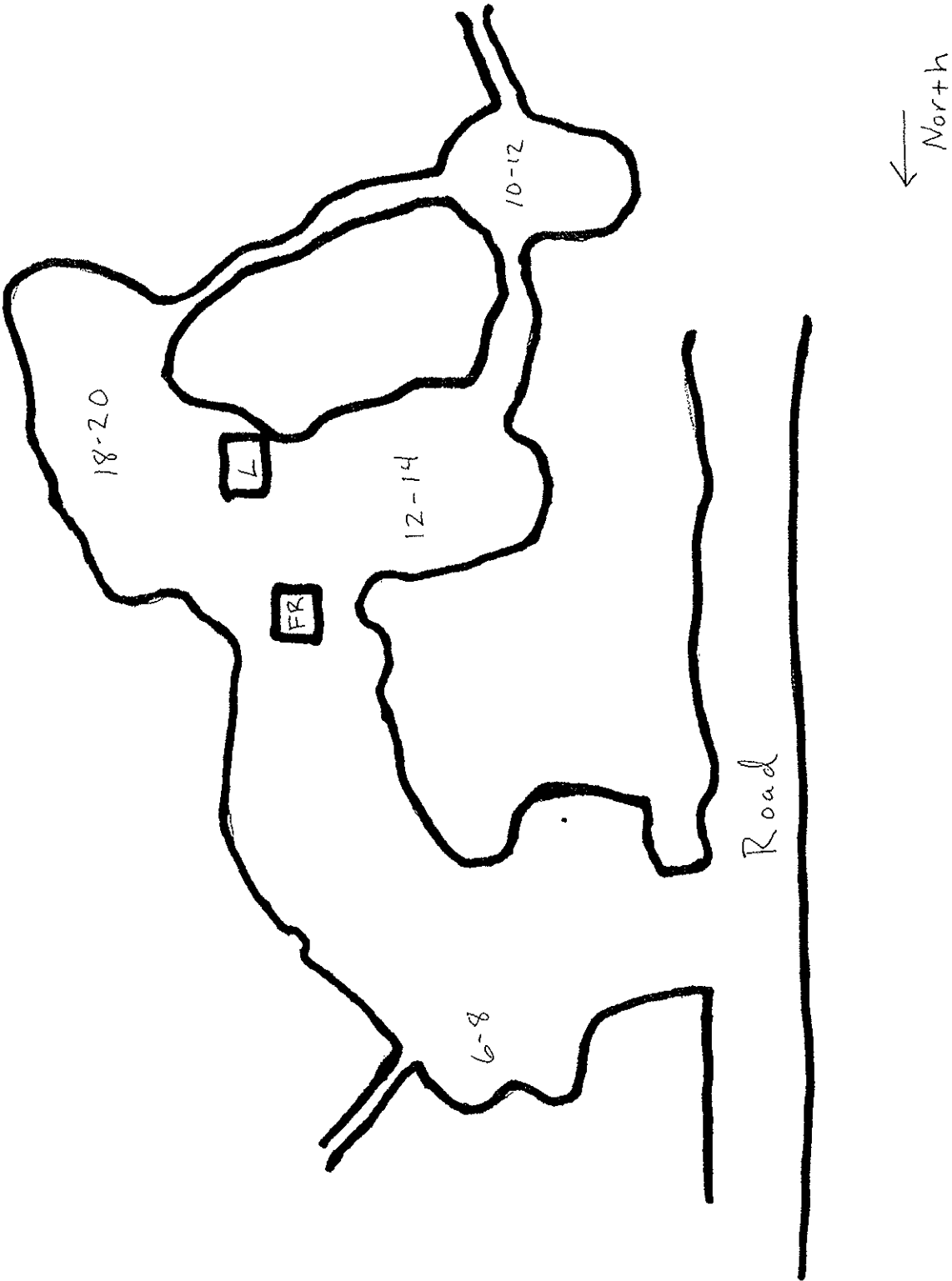

Massasoit

Many Point Lake

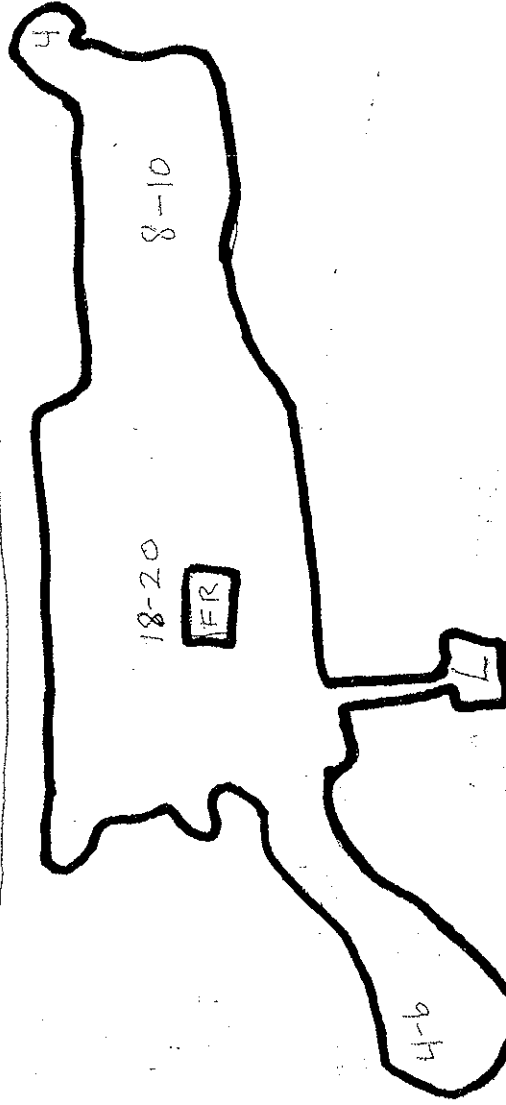

North
↔

First Class Adventure
Program Area

Pontiac

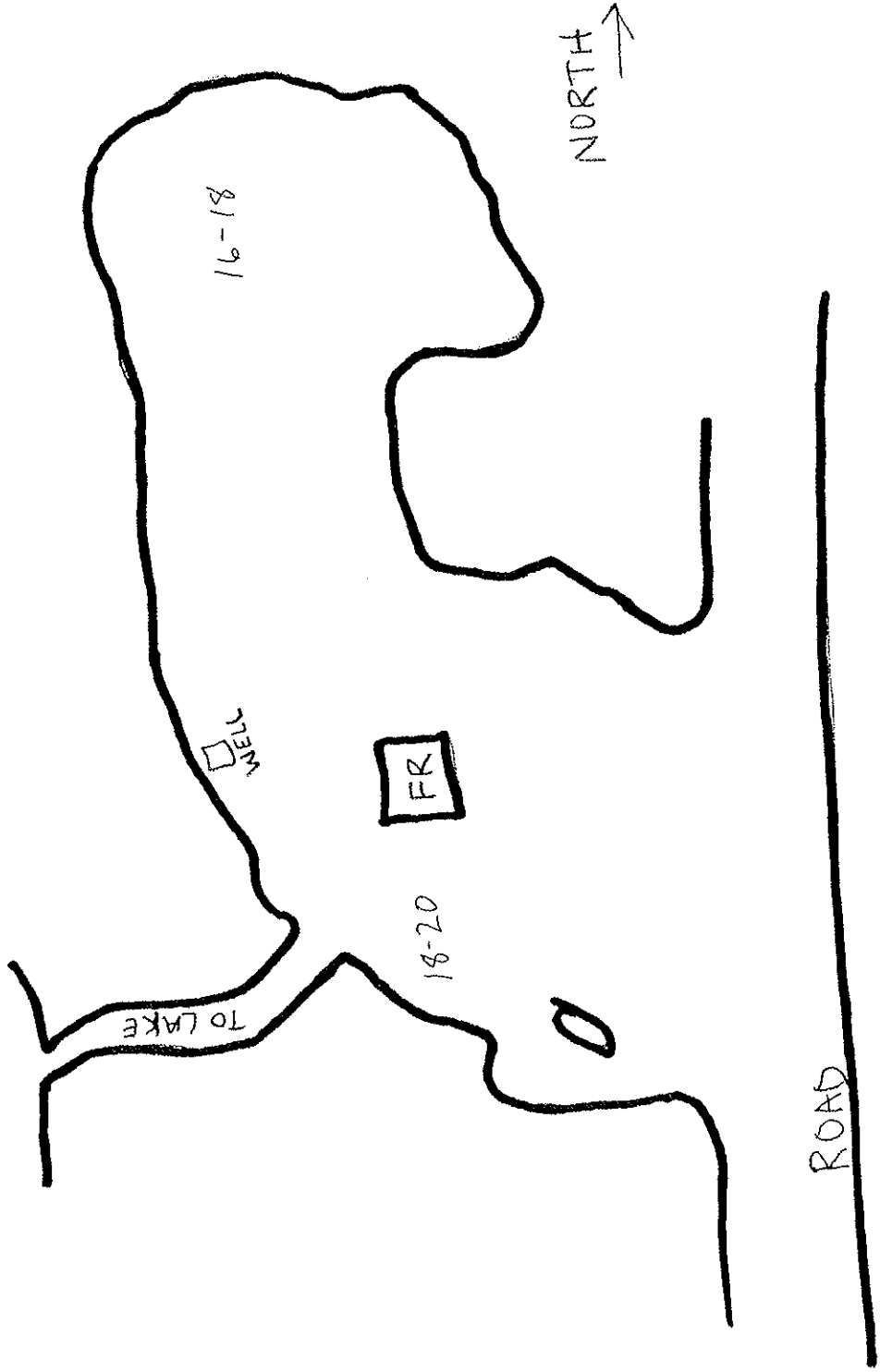

Powhatan

Many Point Lake

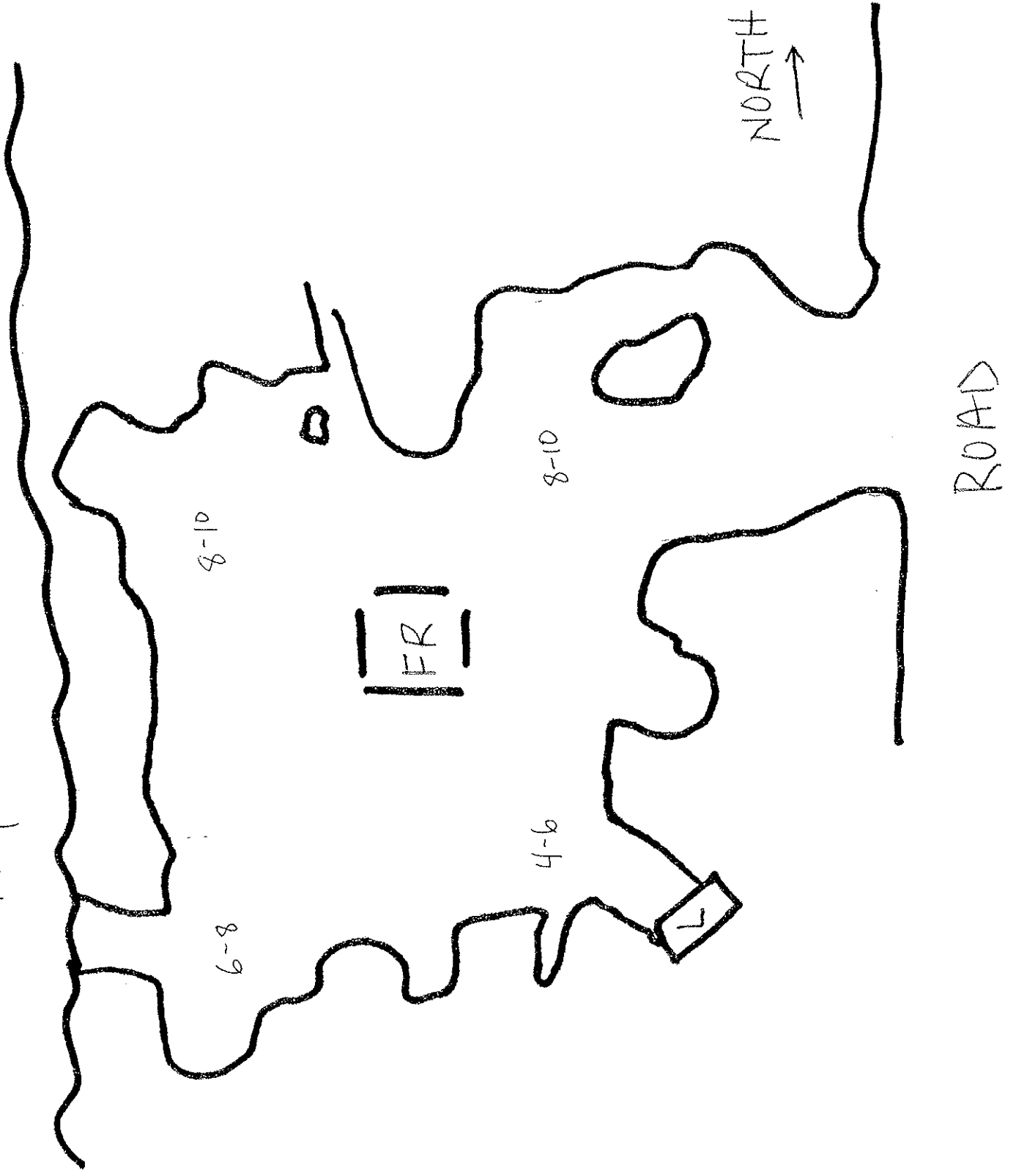

Red Cloud

MANY
POINT
LAKE

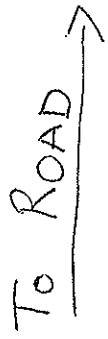
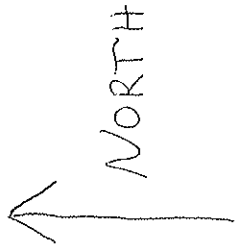

16-18

4-6

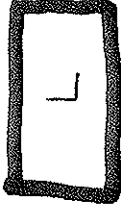

6-8



ROAD

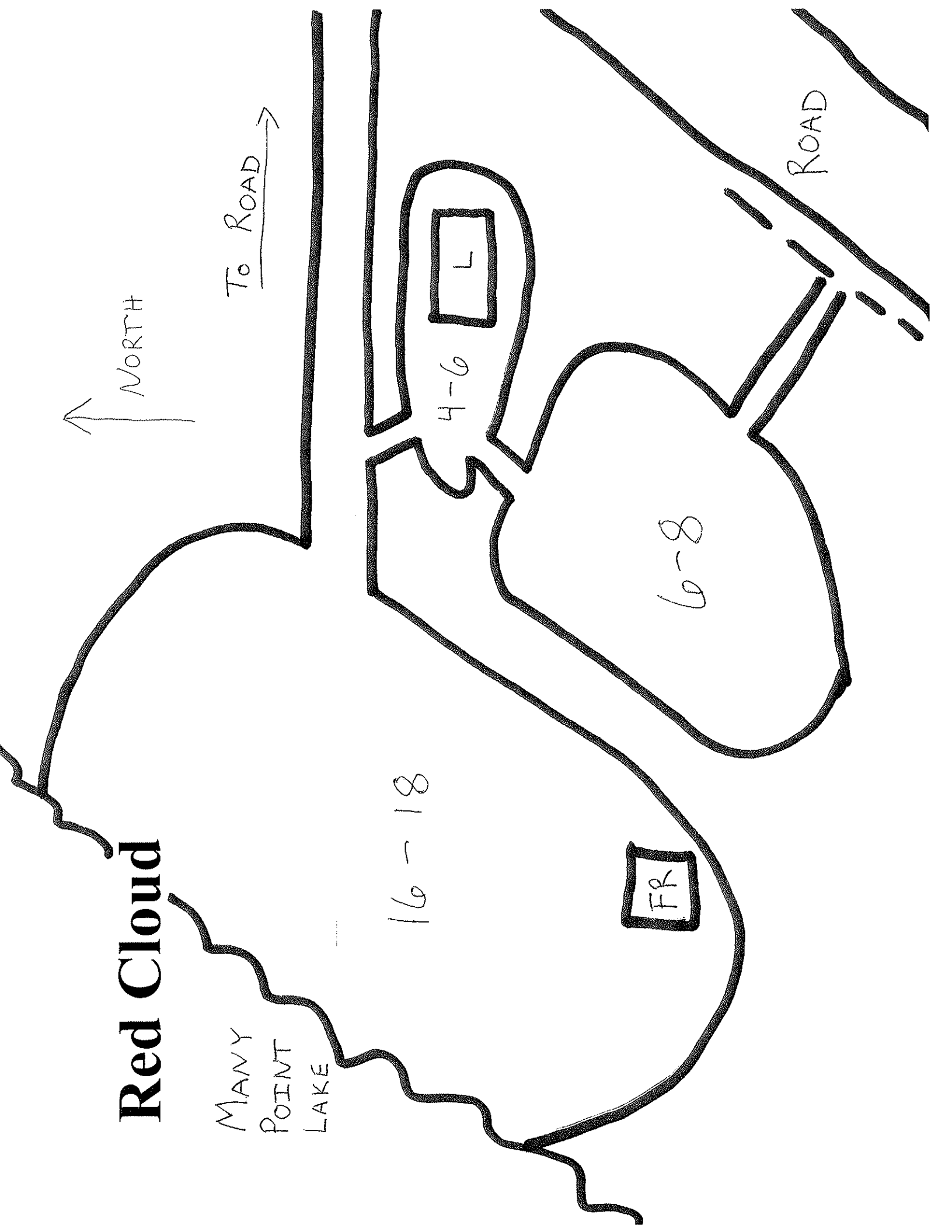

Roman Nose

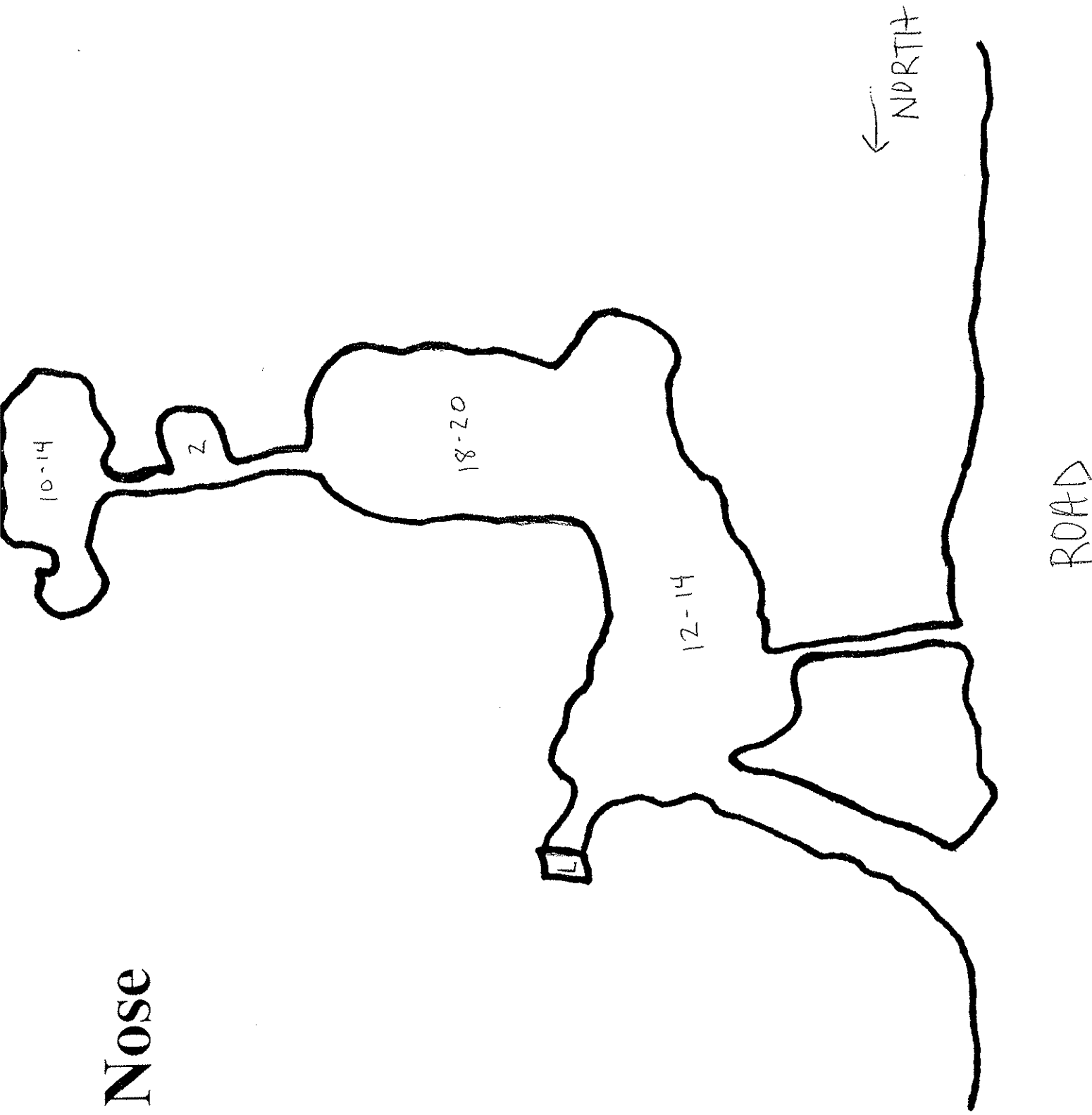

Samoset

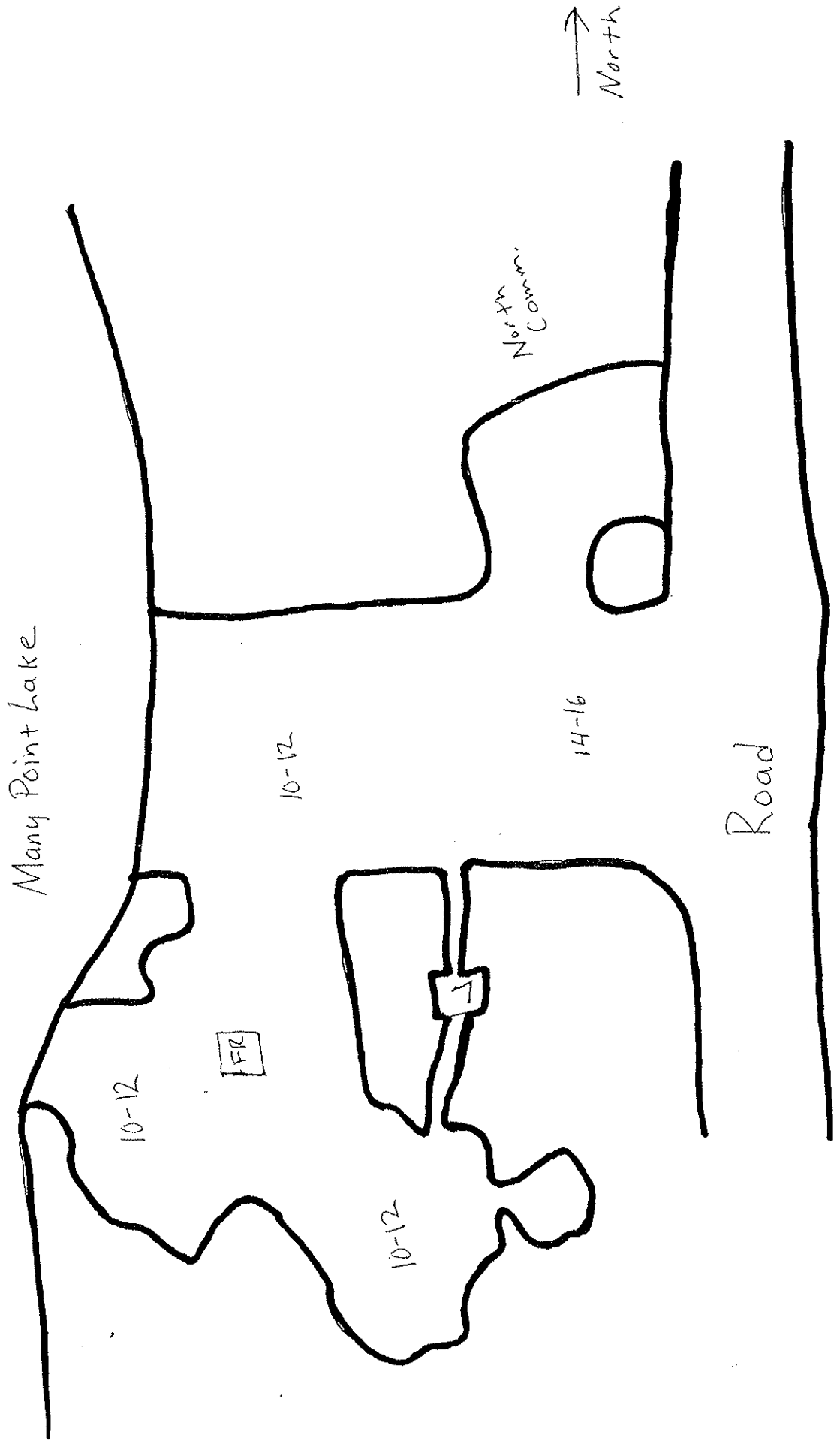

Sequooyah

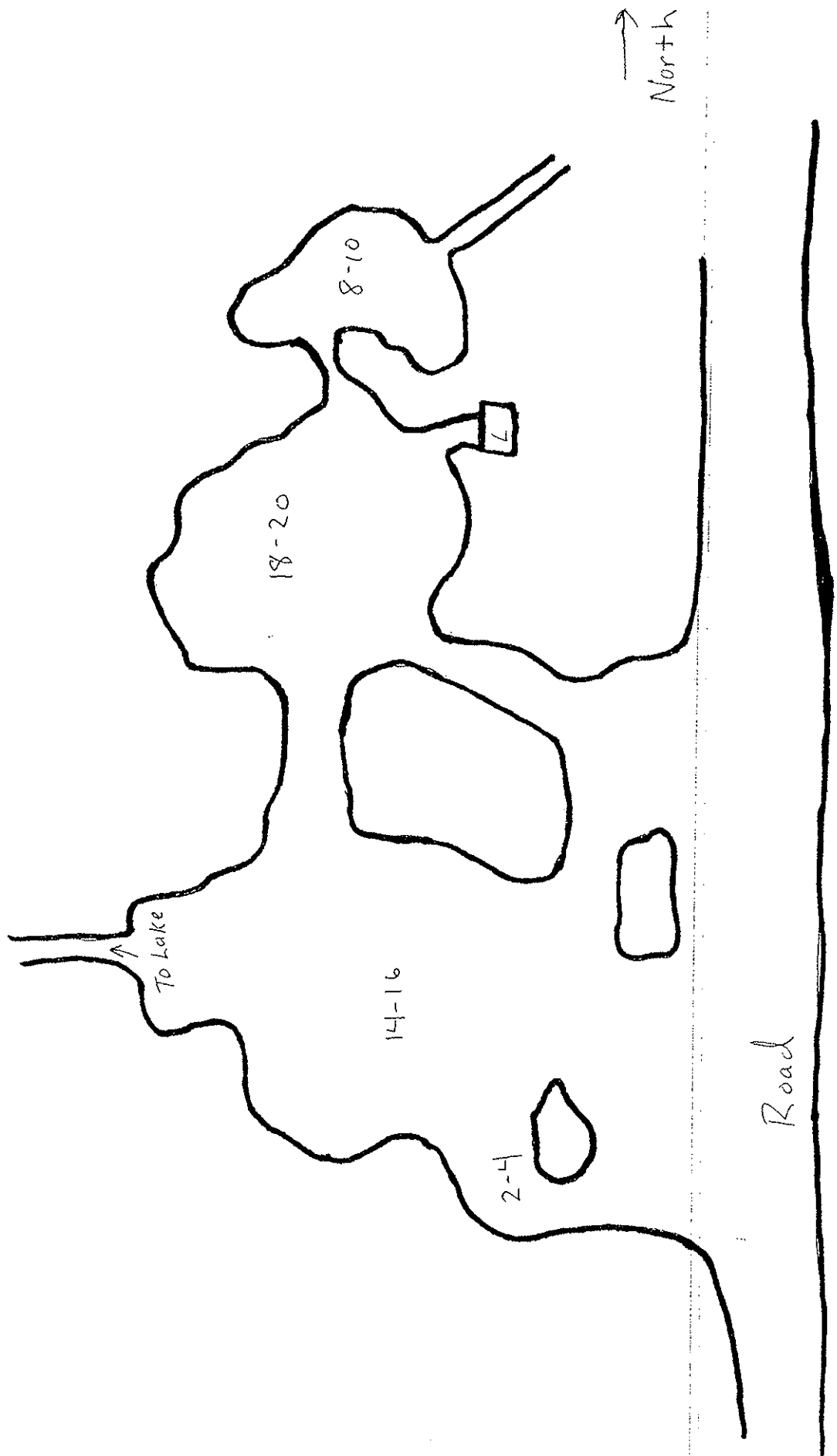

Skenandoah

Many Point Lake

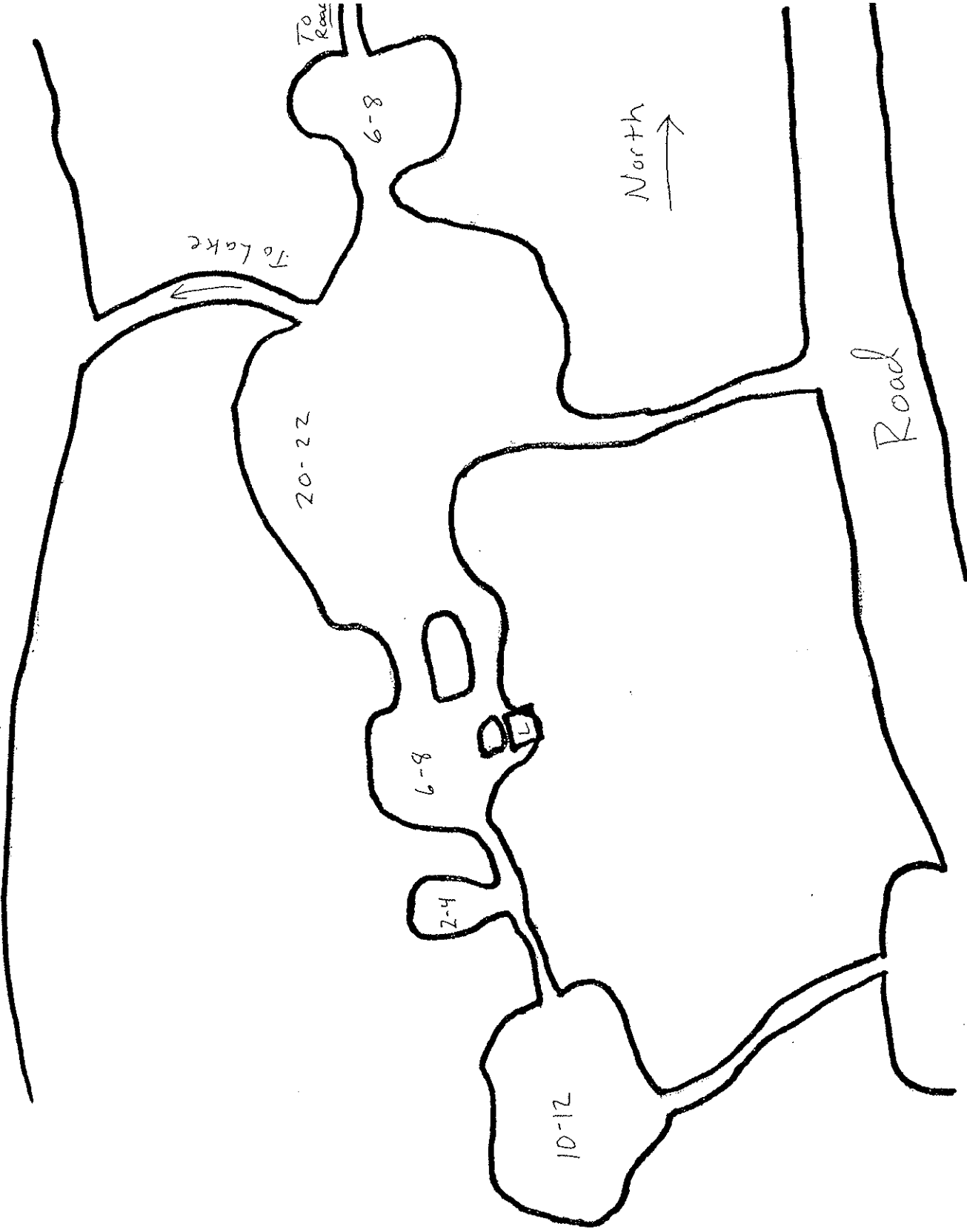

Tamanend

MANY POINT LAKE

TO LAKE

16-18

4-6

14-16

14-16



NORTH
↑

ROAD

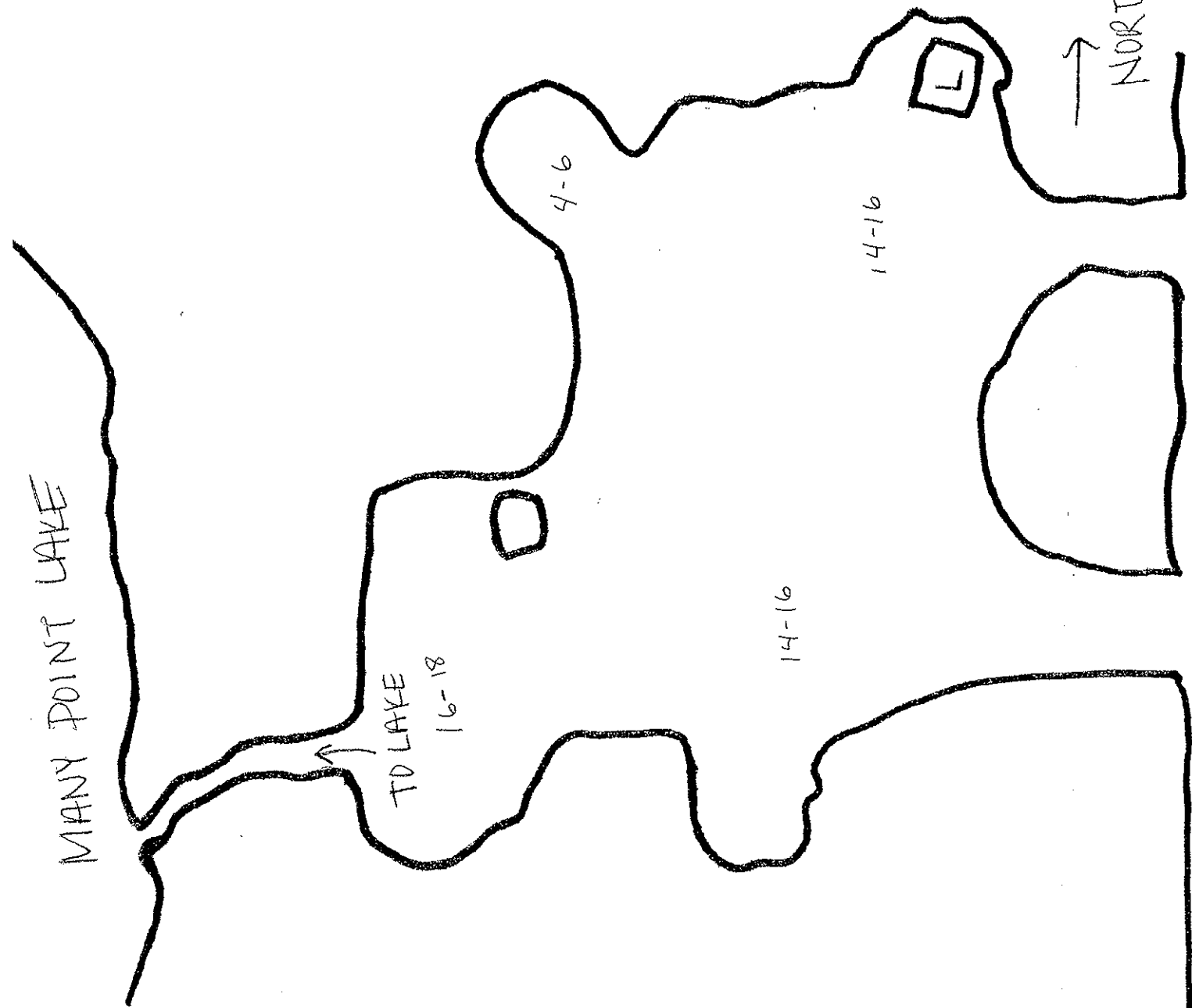

Taskalusu

Mary Point Lake

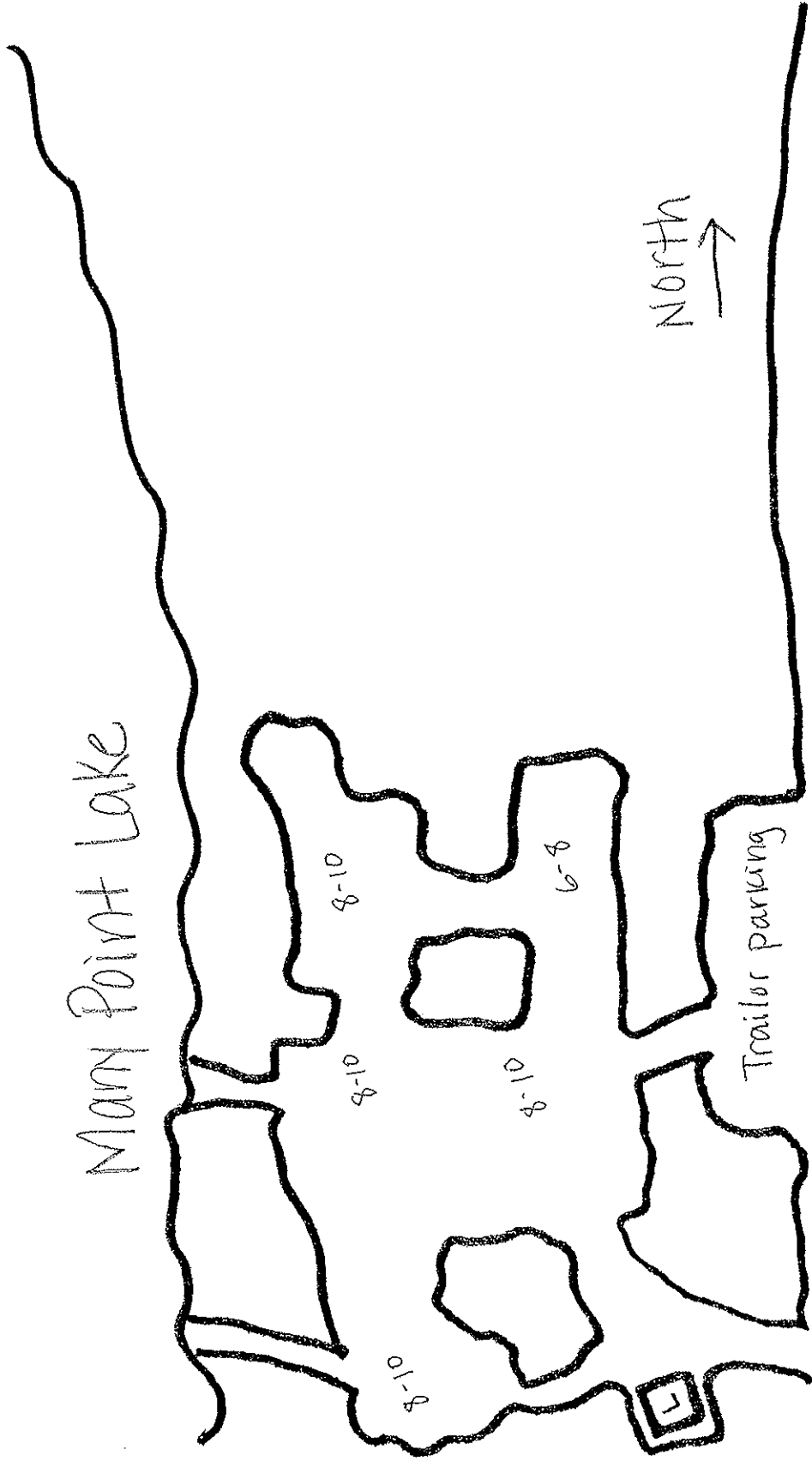

North
↑

Road